

111 Old Well Dr. - Forest Creek at Elon Subdivision - \$289,900



The "Barrett" by Burgess Construction in the Forest Creek at Elon Subdivision... Offered at \$289,900 with 2,116 square feet, the "Barrett" invites you in with its cathedral ceilings and the openness of the main floor. This home features a main floor master suite, large family room, formal dining room and a laundry room off the kitchen. Double doors out to the deck for easy entertaining. The second floor offers 3 bedrooms and a full bath.

Forest Creek at Elon is a new home community in the town of Elon, very close to Elon University. Convenient to shopping, I-85/40 and downtown Burlington, this community offers beautiful quarter-acre wooded lots and quality, custom homes.

DIRECTIONS: Going South on I-85/40, take exit 140; turn right onto University Dr. (becomes Cook Rd.); at end of Cook Rd., turn right onto East 100; go to first light; turn left onto University Dr.; turn left onto O'Kelly (becomes Powerline Rd.); turn left onto Walker Rd. at fire station. Forest Creek at Elon is near end of Walker Rd. on the right.

BURGESS CONSTRUCTION COMPANY

Celebrating over 25 years in business, custom home builder Chet Burgess has been recognized by the National Association of Home Builders as one of America's Best Builders. Chet builds distinctive homes with the inventive use of space, ample amenities and easy livability evident.



Chet's appreciation for good design and his commitment to unsurpassed craftsmanship are key elements in the appeal of Chet Burgess Custom Homes. ..Custom cabinetry of fine hardwoods, intricate molding, perfectly painted walls, beveled glass mirrors, real marble, ceramic tile...He attends to details with care and precision. "I consider it a privilege to build homes that become homes to many fine people..."

Office: (919) 929-0077 • Mobile: (919) 616-5100
Fax: (919) 929-1396 • E-mail: CB32X4@aol.com

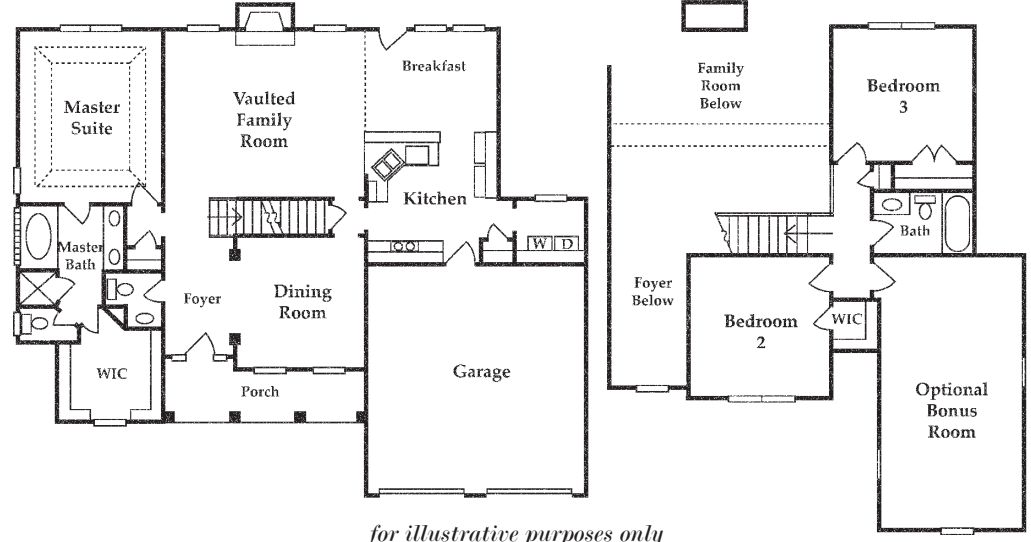

for illustrative purposes only

Construction Acknowledgements:

APPLIANCES: Ferguson Enterprises
 BRICK: Scott Sand Stone
 BRICK CLEANING: Ruben Gonzalez
 CABINETS: Stock Building Supply
 CARPET: Stock Building Supply
 CLOSETS: Tri City Insulation
 CONCRETE SUPPLIER: Chandler Concrete
 CONCRETE FINISHING: Evergreen Nursery
 DEBRIS REMOVAL: JADCO
 DECORATOR: Vicki West-Terrell (Moonlight Designs)
 DESIGN: Frank Betz
 DRYWALL: TLC Drywall
 ELECTRICAL: WLB Electric of Chapel Hill
 EXTERIOR TRIM: John Fredericks Siding
 FINANCING: SouthBank
 FIREPLACE EQUIPMENT: Fireside Hearth & Home

FOOTINGS: Evergreen Nursery
 FRAMING CONTRACTOR: Zuniga Construction
 FRAMING MATERIALS: Stock Building Supply
 GARAGE DOORS: Stock Building Supply
 GRADING & CLEARING: Randy W. Jones/Evergreen
 GRAVEL, SAND, STONE: Martin Marietta Mats
 GUTTERS: Tri City Insulation
 HARDWARE: Stock Bldg/Tri City Insulation
 HARDWOOD FLOORS: Carpet One of Durham
 HEATING/AC: B & T HVAC
 HOUSE CLEANING: Ruben Gonzalez
 INSULATION: Tri City Insulation
 INSURANCE: Insurance People of NC
 LANDSCAPING: Evergreen Nursery
 LAWN MAINTENANCE: Pittman's Landscaping

LIGHTING FIXTURES: Light Unlimited
 LUMBER: Stock Building Supply
 MASONRY CONTRACTOR: Torres Masonry
 MASONRY SUPPLIES: Scott Sand and Stone
 MIRRORS/SHOWER DOORS: Tri City Insulation
 MOLDINGS/TRIM WORK: Int'l Home Developers
 PAINTING CONTRACTOR: Ruben Gonzalez
 PAINT SUPPLIER: Duron
 PLUMBING: North Chatham Plumbing
 PLUMBING SUPPLIER: Wilkerson Plumbing
 PORTABLE TOILET: Piedmont Portables
 REALTOR: ERA Gunn Realty
 ROOFING CONTRACTOR: Juan Hernandez
 ROOFING MATERIALS: Stock Bldg/Orange Truss
 SECURITY SYSTEM: Interstate Home Tech

SIDING CONTRACTOR: John Fredericks Siding
 SOLID SURFACE TOPS: Meyer Decorative Surfaces
 SPECIAL FINANCING INCENTIVES: HomeBank
 STAIRS: Southern Staircase
 STEEL STRUCTURAL: Bill's Iron Work Shop
 STONE CONTRACTOR: Evergreen Nursery/Fireside
 STONE VENEER: Scott Sand and Stone
 SURVEY: Boswell Surveyors
 TERMITE PROTECTION: Terminix
 TILE: Summit Tile/Carpet One of Durham
 TRIM SUPPLIER: Stock Building Supply
 VANITY TOPS: Stock Building Supply
 VINYL FLOOR COVERINGS: Carpet One of Durham
 WATERPROOFING: Evergreen
 WINDOWS/DOORS: Stock Building Supply