

313 Single Tree – Old Fields Subdivision – \$379,900



The “Tyler Clinton” by Burgess Construction in the Old Fields Subdivision –

Offered at \$369,900 with 2,605 square feet and rocking chair front porch. The huge family room with gas log fireplace opens to the breakfast nook and kitchen which features maple cabinets and granite countertops. A screened porch encourages outdoor entertaining with family and friends. The master suite and 3 spacious bedrooms are on the 2nd floor, and the finished 3rd floor offers 570 square feet including a 5th bedroom or office and a media room.

Old Fields is a new home community convenient to both the Triangle and the Triad, combining the charm of a Traditional Neighborhood Design with the most modern conveniences, technologies and amenities.

DIRECTIONS: I-85/40W to exit 150. Turn left on Jimmie Kerr Rd. Pass the Community College and turn left on Cherry Ln. 1/2 mile to stone columns on left.

Office: (919) 929-0077 • Mobile: (919) 616-5100

Fax: (919) 929-1396 • E-mail: CB32X4@aol.com

BURGESS CONSTRUCTION COMPANY

Celebrating over 25 years in business, custom home builder Chet Burgess has been recognized by the National Association of Home Builders as one of America’s Best Builders. Chet builds distinctive homes with the inventive use of space, ample amenities and easy livability evident.



Chet’s appreciation for good design and his commitment to unsurpassed craftsmanship are key elements in the appeal of Chet Burgerr Custom Homes. ..Custom cabinetry of fine hardwoods, intricate molding, perfectly painted walls, beveled glass mirrors, real marble, ceramic tile...He attends to details with care and precision. “I consider it a privilege to build homes that become homes to many fine people...”

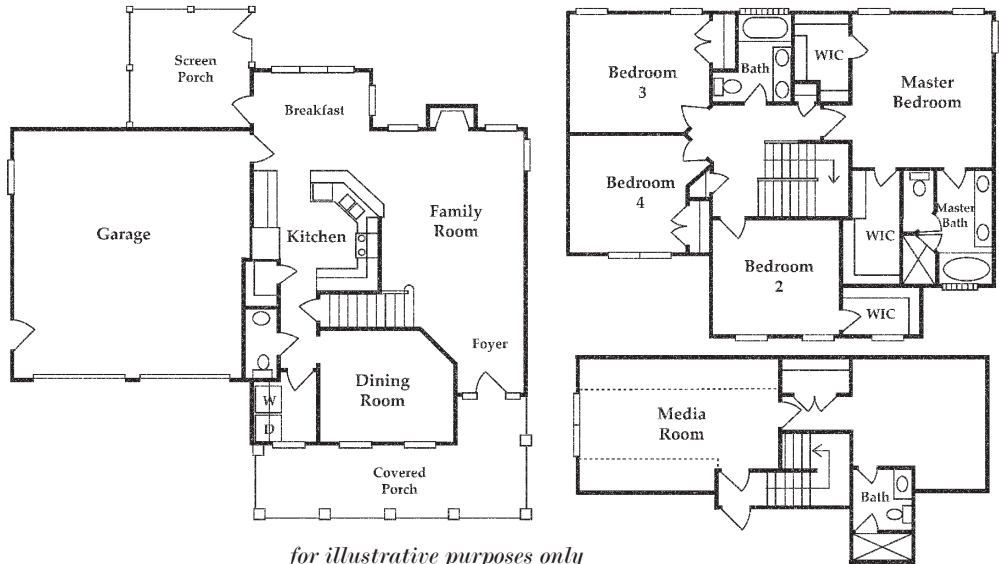

for illustrative purposes only

Construction Acknowledgements:

APPLIANCES: Ferguson Enterprises
 BRICK: Scott Sand and Stone
 BRICK CLEANING: Ruben Gonzalez
 CABINETS: Stock Building Supply
 CARPET: Stock Building Supply
 CLOSETS: Tri City Insulation
 CONCRETE SUPPLIER: Chandler Concrete
 CONCRETE FINISHING: Evergreen Nursery
 DEBRIS REMOVAL: Carolina Septic Tank Svrc.
 DESIGN: Murphy Garnow Design Group
 DRYWALL: TLC Drywall
 ELECTRICAL: WLB Electric of Chapel Hill
 EXTERIOR TRIM: Hernandez Boxing & Siding
 FINANCING: SouthBank
 FIREPLACE EQUIPMENT: Tri City Insulation

FOOTINGS: Evergreen Nursery
 FRAMING CONTRACTOR: Zuniga Construction
 FRAMING MATERIALS: Stock Building Supply
 GARAGE DOORS: Stock Building Supply
 GRADING & CLEARING: Evergreen Nursery
 GRANITE TOPS: Stock Building Supply
 GRAVEL, SAND, STONE: American Stone
 GUTTERS: Tri City Insulation
 HARWARE: Stock Bldg/Tri City Insulation
 HARDWOOD FLOORS: Stock Building Supply
 HEATING/AC: B&T HVAC
 HOUSE CLEANING: Ruben Gonzalez
 INSULATION: Tri City Insulation
 INSURANCE: Insurance People of NC
 LANDSCAPING: Evergreen Nursery

LAWN MAINTENANCE: Pittman’s Landscaping
 LIGHTING FIXTURES: Light Unlimited
 LUMBER: Stock Building Supply
 MASONRY CONTRACTOR: Torres Masonry
 MASONRY SUPPLIES: Scott Sand and Stone
 MIRRORS/SHOWER DOORS: Tri City Insulation
 MOLDINGS/TRIM WORK: Int’l Home Developers
 PAINTING CONTRACTOR: Ruben Gonzalez
 PAINT SUPPLIER: Duron
 PLUMBING: North Chatham Plumbing
 PLUMBING SUPPLIER: Wilkerson Plumbing
 PORTABLE TOILET: Piedmont Portables
 REALTOR: Howard Perry & Walston
 ROOFING CONTRACTOR: Hernandez Roofing
 ROOFING MATERIALS: Stock Building Supply

SECURITY SYSTEM: Interstate Home Tech
 SIDING CONTRACTOR: Hernandex Boxing/Siding
 SPECIAL FINANCING & INCENTIVES: HomeBanc
 STAIRS: Southern Staircase
 STEEL STRUCTURAL: Bill’s Iron Work Shop
 STONE CONTRACTOR: Evergreen Nursery
 STONE VENEER: Scott Sand and Stone
 SURVEY: Boswell Surveyors
 TERMITE PROTECTION: Terminx
 TILE: Stock Building Supply
 TRIM SUPPLIER: Stock Building Supply
 VANITY TOPS: Stock Building Supply
 WATERPROOFING: Evergreen
 WINDOWS/DOORS: Stocking Building Supply